

NG6

NEXT GENERATION

NEXT GENERATION 6
— FRACTIONAL —

sgspro

sgspro

NG6
NEXT GENERATION

Innovative, patent pending geometry, developed and engineered by ATA, to accelerate the manufacturing process and increase product life.

Why choose the NEXT GENERATION 6?

By choosing the NEXT GENERATION 6, you will achieve huge reductions in time and effort. Combining innovative, patent-pending geometry with the very latest in coating technology, productivity is sustained and longevity is further improved without negatively affecting the vibration for the user.

With the NEXT GENERATION *ACCELERATOR* coating, stock removal is up to DOUBLE that of other leading premium-quality burs serving this market.

The aggressive geometry greatly improves cutting performance and finishing capabilities, providing a reduction in process costs for heavy stock removal applications.

Manufactured from high quality tungsten carbide at our state-of-the-art manufacturing facility, which guarantees consistent performance and high quality to ISO 9001:2015.

Combined with an ATA Industrial Air Tool, the NEXT GENERATION 6 will give a guaranteed smoother grinding operation.

The patent pending flute geometry is developed with a primary relief, which significantly increases the life of the bur.

- Significantly increased metal removal rates
- Reduced operator grinding time
- Aggressive geometry greatly improves cutting performance
- Reduced component machine time

Resulting in the reduction of overall manufacturing costs

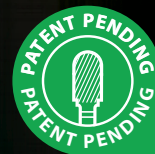

SPECIALLY DESIGNED TO RAPIDLY REMOVE STOCK, INCREASE PRODUCTIVITY AND EXTEND PRODUCT LIFE



Available Bur Shapes and Cut Applications

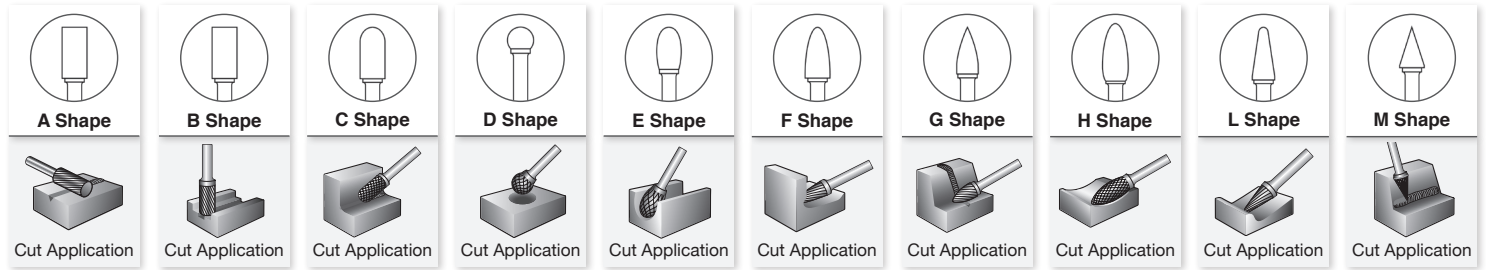

Recommended Operating Speeds

The following operating speeds are a recommended guide for the usage of tungsten carbide burs, based on the bur head diameter.

Bur Head ϕ	Maximum Operating Speed	Cast Iron		Unhardened Steel		Hardened Steel, Stainless Steel	
		Speed Range	Recommended Start Point	Speed Range	Recommended Start Point	Speed Range	Recommended Start Point
1/4" (6mm)	65	22-60	45	45-60	50	30-45	40
3/8" (10mm)	55	15-40	30	30-40	30	19-30	25
1/2" (12mm)	35	11-30	25	22-30	25	15-22	20
5/8" (16mm)	25	9-20	20	18-20	20	12-18	15
3/4" (20mm)	20	8-17	12	15-17	15	10-15	10
1" (25mm)	15	6-13	10	10-13	10	7-11	8

All speeds in the table above are X 1,000 rpm.

WARNING: These are recommended speeds for Standard Length Burs based on 1 3/4" shank length and 1/2" maximum overhang.

PERFORMANCE

NG6
NEXT GENERATION



NEXT GENERATION 6 removes up to **75% more** stock on Mild Steel during the first 5 minutes of grinding when tested against other leading premium-quality double cut burs.



Cumulative stock removal on Stainless Steel over 15 minutes is **over 50%** for the NEXT GENERATION 6.

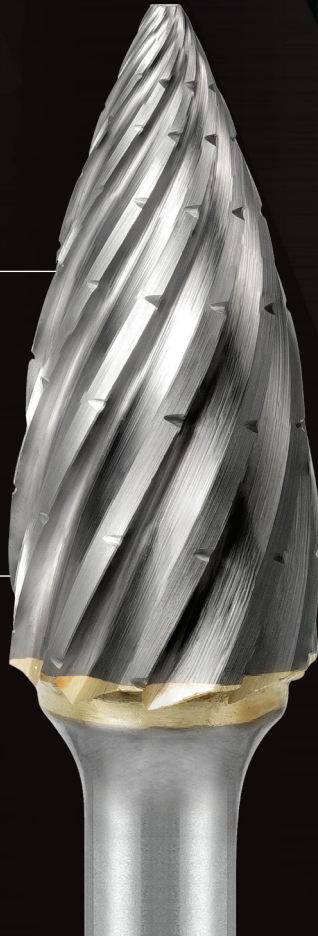

NG6
NEXT GENERATION
ACCELERATOR



With the *ACCELERATOR* coating, the rate of stock removal is up to **DOUBLE** that of other leading double cut burs.



Cumulative stock removal is in **excess of 100%** with the unique *ACCELERATOR* coating.

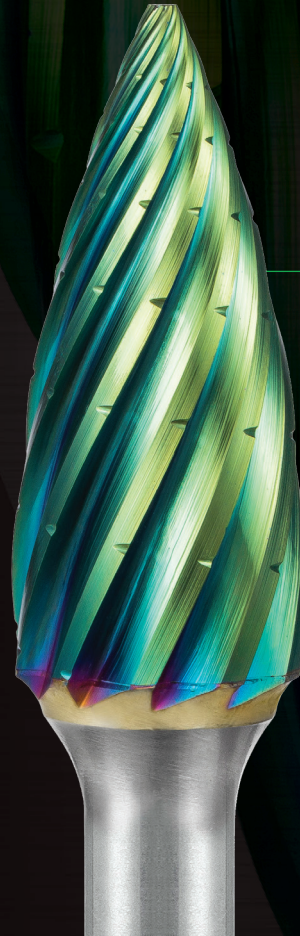



Material Application

The NEXT GENERATION 6, along with the coated *ACCELERATOR* option, outperforms all comparable carbide burs on Steel, Stainless Steel, Mild Steel and Cast Iron.

Target Industries

The NEXT GENERATION 6 is the solution to accelerate manufacturing processes in industry applications where rapid stock removal is required, including;

- Shipbuilding
- Foundries
- Heavy Metal Fabrication
- Oil & Gas
- Automotive
- Rail

Highlight

NEXT GENERATION 6 - featuring an innovative, patent pending geometry that combines a unique profiled fluting with low cross cut and a primary relief. Combined with the very latest in coating technology, never before used with carbide burs, the NEXT GENERATION 6 delivers;

- Significantly increased metal removal rates
- Reduced operator grinding time
- Aggressive geometry greatly improves cutting performance
- Reduced component machine time

Resulting in the reduction of overall manufacturing costs.

NEXT GENERATION 6 ACCELERATOR Range

NG6 A - Cylinder without endcut		Shape	Tool No.	Cutting Diameter	Length of Cut	Shank Diameter	Overall Length	Product Code
	A, ZYA, SA	SA-1	1/4"	5/8"	1/4"	2"	19750	
	A, ZYA, SA	SA-2	5/16"	3/4"	1/4"	2-1/2"	19751	
	A, ZYA, SA	SA-3	3/8"	3/4"	1/4"	2-1/2"	19752	
	A, ZYA, SA	SA-5	1/2"	1"	1/4"	2-3/4"	19753	
	A, ZYA, SA	SA-6	5/8"	1"	1/4"	2-3/4"	19754	
NG6 B - Cylinder with endcut		Shape	Tool No.	Cutting Diameter	Length of Cut	Shank Diameter	Overall Length	Product Code
	B, ZYAS, SB	SB-1	1/4"	5/8"	1/4"	2"	19755	
	B, ZYAS, SB	SB-2	5/16"	3/4"	1/4"	2-1/2"	19756	
	B, ZYAS, SB	SB-3	3/8"	3/4"	1/4"	2-1/2"	19757	
	B, ZYAS, SB	SB-5	1/2"	1"	1/4"	2-3/4"	19758	
	B, ZYAS, SB	SB-6	5/8"	1"	1/4"	2-3/4"	19759	
NG6 C - Ball Nosed Cylinder		Shape	Tool No.	Cutting Diameter	Length of Cut	Shank Diameter	Overall Length	Product Code
	C, WRC, SC	SC-1	1/4"	5/8"	1/4"	2"	19760	
	C, WRC, SC	SC-2	5/16"	3/4"	1/4"	2-1/2"	19761	
	C, WRC, SC	SC-3	3/8"	3/4"	1/4"	2-1/2"	19762	
	C, WRC, SC	SC-5	1/2"	1"	1/4"	2-3/4"	19763	
	C, WRC, SC	SC-6	5/8"	1"	1/4"	2-3/4"	19764	
NG6 D - Ball Shape		Shape	Tool No.	Cutting Diameter	Length of Cut	Shank Diameter	Overall Length	Product Code
	D, KUD, SD	SD-1	1/4"	7/32"	1/4"	2"	19765	
	D, KUD, SD	SD-2	5/16"	1/4"	1/4"	2"	19766	
	D, KUD, SD	SD-3	3/8"	5/16"	1/4"	2-1/16"	19767	
	D, KUD, SD	SD-5	1/2"	7/16"	1/4"	2-1/8"	19768	
	D, KUD, SD	SD-6	5/8"	9/16"	1/4"	2-1/4"	19769	
NG6 E - Oval Shape		Shape	Tool No.	Cutting Diameter	Length of Cut	Shank Diameter	Overall Length	Product Code
	E, TRE, SE	SE-1	1/4"	3/8"	1/4"	2"	19770	
	E, TRE, SE	SE-2	5/16"	5/8"	1/4"	2-3/8"	19771	
	E, TRE, SE	SE-3	3/8"	5/8"	1/4"	2-3/8"	19772	
	E, TRE, SE	SE-5	1/2"	7/8"	1/4"	2-5/8"	19773	
	E, TRE, SE	SE-6	5/8"	1"	1/4"	2-3/4"	19774	

NEXT GENERATION 6 ACCELERATOR Range



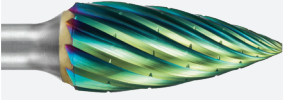
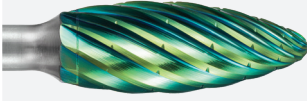
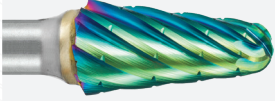
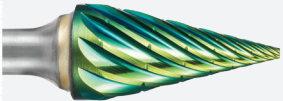

NG6 F - Ball Nosed Tree Shape		Shape	Tool No.	Cutting Diameter	Length of Cut	Shank Diameter	Overall Length	Product Code
	F, RBF, SF	SF-1	1/4"	5/8"	1/4"	2"	19775	
	F, RBF, SF	SF-2	5/16"	3/4"	1/4"	2-1/2"	19776	
	F, RBF, SF	SF-3	3/8"	3/4"	1/4"	2-1/2"	19777	
	F, RBF, SF	SF-5	1/2"	1"	1/4"	2-3/4"	19778	
	F, RBF, SF	SF-6	5/8"	1"	1/4"	2-3/4"	19779	
NG6 G - Pointed Tree Shape		Shape	Tool No.	Cutting Diameter	Length of Cut	Shank Diameter	Overall Length	Product Code
	G, SPG, SG	SG-1	1/4"	5/8"	1/4"	2"	19780	
	G, SPG, SG	SG-2	5/16"	3/4"	1/4"	2-1/2"	19781	
	G, SPG, SG	SG-3	3/8"	3/4"	1/4"	2-1/2"	19782	
	G, SPG, SG	SG-5	1/2"	1"	1/4"	2-3/4"	19783	
	G, SPG, SG	SG-6	5/8"	1"	1/4"	2-3/4"	19784	
NG6 H - Flame Shape		Shape	Tool No.	Cutting Diameter	Length of Cut	Shank Diameter	Overall Length	Product Code
	H, SH	SH-1	1/4"	5/8"	1/4"	2"	19785	
	H, SH	SH-2	5/16"	3/4"	1/4"	2-1/2"	19786	
	H, SH	SH-3	3/8"	3/4"	1/4"	2-1/2"	19787	
	H, SH	SH-5	1/2"	1-1/4"	1/4"	3"	19788	
	H, SH	SH-6	5/8"	1-7/16"	1/4"	3-1/8"	19789	
NG6 L - Ball Nosed Cone Shape		Shape	Tool No.	Cutting Diameter	Length of Cut	Shank Diameter	Overall Length	Product Code
	L, KEL, SL	SL-1	1/4"	5/8"	1/4"	2"	19790	
	L, KEL, SL	SL-2	5/16"	1"	1/4"	2-3/4"	19791	
	L, KEL, SL	SL-3	3/8"	3/4"	1/4"	2-1/2"	19792	
	L, KEL, SL	SL-4	1/2"	1-1/8"	1/4"	3"	19793	
	L, KEL, SL	SL-5	5/8"	1-3/16"	1/4"	3-1/16"	19794	
NG6 M - Cone Shape		Shape	Tool No.	Cutting Diameter	Length of Cut	Shank Diameter	Overall Length	Product Code
	M, SKM, SM	SM-2	1/4"	3/4"	1/4"	2"	19795	
	M, SKM, SM	SM-3	5/16"	3/4"	1/4"	2-1/2"	19796	
	M, SKM, SM	SM-4	3/8"	3/4"	1/4"	2-1/2"	19797	
	M, SKM, SM	SM-5	1/2"	7/8"	1/4"	2-3/4"	19798	
	M, SKM, SM	SM-6	5/8"	1"	1/4"	2-7/8"	19799	

Bur sets available

NEXT GENERATION 6 Range

NG6 A - Cylinder without endcut	Shape	Tool No.	Cutting Diameter	Length of Cut	Shank Diameter	Overall Length	Product Code
	A, ZYA, SA	SA-1	1/4"	5/8"	1/4"	2"	19600
	A, ZYA, SA	SA-2	5/16"	3/4"	1/4"	2-1/2"	19601
	A, ZYA, SA	SA-3	3/8"	3/4"	1/4"	2-1/2"	19602
	A, ZYA, SA	SA-5	1/2"	1"	1/4"	2-3/4"	19603
	A, ZYA, SA	SA-6	5/8"	1"	1/4"	2-3/4"	19604
NG6 B - Cylinder with endcut	Shape	Tool No.	Cutting Diameter	Length of Cut	Shank Diameter	Overall Length	Product Code
	B, ZYAS, SB	SB-1	1/4"	5/8"	1/4"	2"	19605
	B, ZYAS, SB	SB-2	5/16"	3/4"	1/4"	2-1/2"	19606
	B, ZYAS, SB	SB-3	3/8"	3/4"	1/4"	2-1/2"	19607
	B, ZYAS, SB	SB-5	1/2"	1"	1/4"	2-3/4"	19608
	B, ZYAS, SB	SB-6	5/8"	1"	1/4"	2-3/4"	19609
NG6 C - Ball Nosed Cylinder	Shape	Tool No.	Cutting Diameter	Length of Cut	Shank Diameter	Overall Length	Product Code
	C, WRC, SC	SC-1	1/4"	5/8"	1/4"	2"	19610
	C, WRC, SC	SC-2	5/16"	3/4"	1/4"	2-1/2"	19611
	C, WRC, SC	SC-3	3/8"	3/4"	1/4"	2-1/2"	19612
	C, WRC, SC	SC-5	1/2"	1"	1/4"	2-3/4"	19613
	C, WRC, SC	SC-6	5/8"	1"	1/4"	2-3/4"	19614
	C, WRC, SC	SC-6	5/8"	1"	1/4"	2-3/4"	19614
NG6 D - Ball Shape	Shape	Tool No.	Cutting Diameter	Length of Cut	Shank Diameter	Overall Length	Product Code
	D, KUD, SD	SD-1	1/4"	7/32"	1/4"	2"	19615
	D, KUD, SD	SD-2	5/16"	1/4"	1/4"	2"	19616
	D, KUD, SD	SD-3	3/8"	5/16"	1/4"	2-1/16"	19617
	D, KUD, SD	SD-5	1/2"	7/16"	1/4"	2-1/8"	19618
	D, KUD, SD	SD-6	5/8"	9/16"	1/4"	2-1/4"	19619
	D, KUD, SD	SD-6	5/8"	9/16"	1/4"	2-1/4"	19619
NG6 E - Oval Shape	Shape	Tool No.	Cutting Diameter	Length of Cut	Shank Diameter	Overall Length	Product Code
	E, TRE, SE	SE-1	1/4"	3/8"	1/4"	2"	19620
	E, TRE, SE	SE-2	5/16"	5/8"	1/4"	2-3/8"	19621
	E, TRE, SE	SE-3	3/8"	5/8"	1/4"	2-3/8"	19622
	E, TRE, SE	SE-5	1/2"	7/8"	1/4"	2-5/8"	19623
	E, TRE, SE	SE-6	5/8"	1"	1/4"	2-3/4"	19624
	E, TRE, SE	SE-6	5/8"	1"	1/4"	2-3/4"	19624

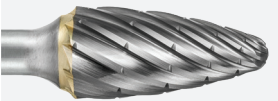
NEXT GENERATION 6 Range

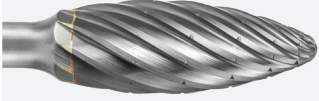
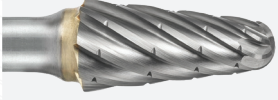
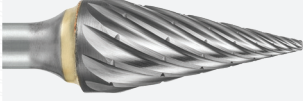
NG6 F - Ball Nosed Tree Shape		Shape	Tool No.	Cutting Diameter	Length of Cut	Shank Diameter	Overall Length	Product Code
	F, RBF, SF	SF-1	1/4"	5/8"	1/4"	2"	19625	
	F, RBF, SF	SF-2	5/16"	3/4"	1/4"	2-1/2"	19626	
	F, RBF, SF	SF-3	3/8"	3/4"	1/4"	2-1/2"	19627	
	F, RBF, SF	SF-5	1/2"	1"	1/4"	2-3/4"	19628	
	F, RBF, SF	SF-6	5/8"	1"	1/4"	2-3/4"	19629	
NG6 G - Pointed Tree Shape		Shape	Tool No.	Cutting Diameter	Length of Cut	Shank Diameter	Overall Length	Product Code
	G, SPG, SG	SG-1	1/4"	5/8"	1/4"	2"	19630	
	G, SPG, SG	SG-2	5/16"	3/4"	1/4"	2-1/2"	19631	
	G, SPG, SG	SG-3	3/8"	3/4"	1/4"	2-1/2"	19632	
	G, SPG, SG	SG-5	1/2"	1"	1/4"	2-3/4"	19633	
	G, SPG, SG	SG-6	5/8"	1"	1/4"	2-3/4"	19634	
NG6 H - Flame Shape		Shape	Tool No.	Cutting Diameter	Length of Cut	Shank Diameter	Overall Length	Product Code
	H, SH	SH-1	1/4"	5/8"	1/4"	2"	19635	
	H, SH	SH-2	5/16"	3/4"	1/4"	2-1/2"	19636	
	H, SH		3/8"	3/4"	1/4"	2-1/2"	19637	
	H, SH	SH-5	1/2"	1-1/4"	1/4"	3"	19638	
	H, SH	SH-6	5/8"	1-7/16"	1/4"	3-1/8"	19639	
NG6 L - Ball Nosed Cone Shape		Shape	Tool No.	Cutting Diameter	Length of Cut	Shank Diameter	Overall Length	Product Code
	L, KEL, SL	SL-1	1/4"	5/8"	1/4"	2"	19640	
	L, KEL, SL	SL-2	5/16"	1"	1/4"	2-3/4"	19641	
	L, KEL, SL		3/8"	3/4"	1/4"	2-1/2"	19642	
	L, KEL, SL	SL-4	1/2"	1-1/8"	1/4"	3"	19643	
	L, KEL, SL	SL-5	5/8"	1-3/16"	1/4"	3-1/16"	19644	
NG6 M - Cone Shape		Shape	Tool No.	Cutting Diameter	Length of Cut	Shank Diameter	Overall Length	Product Code
	M, SKM, SM	SM-2	1/4"	3/4"	1/4"	2"	19645	
	M, SKM, SM		5/16"	3/4"	1/4"	2-1/2"	19646	
	M, SKM, SM	SM-4	3/8"	3/4"	1/4"	2-1/2"	19647	
	M, SKM, SM	SM-5	1/2"	7/8"	1/4"	2-3/4"	19648	
	M, SKM, SM	SM-6	5/8"	1"	1/4"	2-7/8"	19649	

Metal Fabrication

Particularly effective in the fabrication of heavy material components, the NEXT GENERATION 6 effectively removes up to double the amount of stock when tested against other leading double cut burs, leaving a smooth finish. Perfect for weld removal, removing imperfections, machining, shaping and enlarging holes. The flute geometry offers a larger cutting area while prolonging the life of the bur.

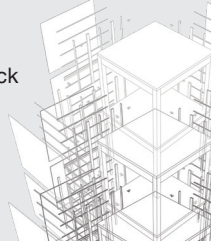

Foundries

In foundries, burs are required to finish and remove stock in the most challenging conditions. The NEXT GENERATION 6 bur is engineered to improve productivity and user comfort by removing in excess of 100% more metal than other double cut burs on the market. The cutting and finishing capabilities ensures a high quality finish with a longer product and tool life.

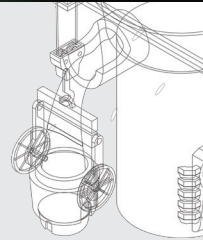

Marine

The marine industry faces ongoing challenges with a growing competitive landscape, safety legislation and cost-reduction programs. Our objective is to increase productivity and to reduce downtime without compromising on quality and operators' safety. The NEXT GENERATION 6 performs especially well on steel, cast iron and stainless steel stock removal and finishing applications in fabrication and assembly.

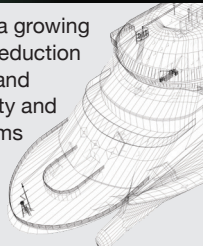

Automotive

Our product portfolio is dedicated to providing customers with deburring and grinding solutions to suit all applications. Our enhanced range of NEXT GENERATION 6 burs, can be effectively used on cast iron, stainless steel and steel applications, for automotive body and engine build and repair.

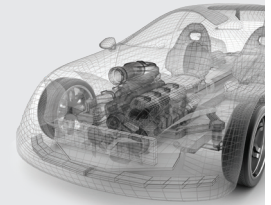

Railway

With increased demand for mass transit and significant plans for investment in global rail infrastructure, the cost saving benefits of the NEXT GENERATION 6 will improve productivity across the industry. The NEXT GENERATION 6 is particularly effective on steel, cast iron and stainless steel where stock removal is required.

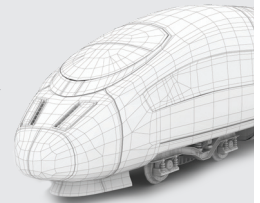

Oil & Gas

Platform maintenance and construction, power station refurbishment, drill head manufacturing and maintenance are carried out under some of the harshest working conditions. The NEXT GENERATION 6 bur can offer faster stock removal and improved efficiency on heavy materials. The NEXT GENERATION 6 provides proven results in efficient cutting and grinding performance.

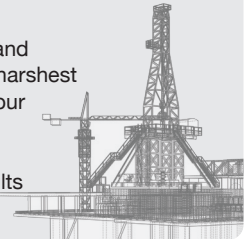

NG6

NEXT GENERATION



**NEXT
GENERATION 6
ACCELERATOR**
coating gives up to **DOUBLE** the rate of stock removal



More aggressive and effective cutting and finishing



Patent pending



Longer product life



ISO certified



Cost reducing solution for heavy stock removal applications

ATA



Established in 1963, ATA is the world's leading manufacturer and distributor of tungsten carbide burs. The company also offer customers an extensive range of Abrasives, Industrial Air Tools and Cutting Tools which are sold in over eighty countries globally.

The company has state-of-the-art facilities in Ireland, the UK, the US and Germany. ATA products are now sold in 85 countries around the world, with advanced manufacturing plants, along with research and development centers and sales offices in three continents.

For over 55 years, ATA have been making burs to the highest specification in the market. We have advised and served customers by combining technical expertise and the highest standard of manufacturing technologies to lead the market in innovative solutions.



- ATA Manufacturing, R&D and Sales Center
- ATA Sales Office
- ATA Manufacturing Plant and Sales Center
- Areas covered by Distribution
- Distribution Center and Sales Office

INTERNATIONAL OFFICES

ATA Tools Ltd., IDA Business
& Technology Park, Killygarry, Cavan,
Co. Cavan, H12 DK46, Ireland

T: +353 (0) 49 432 6178

F: +353 (0) 49 432 6298

E: sales@atagroup.ie

W: atagroup.com/NG6

UK OFFICES

ATA Garryson Ltd., Spring Road,
Ibstock, Leicestershire, LE67 6LR,
United Kingdom

T: +44 (0) 1530 261 145

F: +44 (0) 1530 262 801

E: sales@atagarryson.com

W: atagroup.com/NG6

US OFFICES

ATA Tools Inc., 7 Ascot Parkway,
Cuyahoga Falls, Ohio 44223,
USA

T: +1 330 928 7744

F: +1 330 849 2977

E: ataorders@ataatools.com

W: atagroup.com/NG6

NG6
NEXT GENERATION

sgspro